

Coat Hooks - Slim Line

Specification

- Stainless steel AISI Grade 304
- Circular and square designs

Features

- Aesthetic slim profile
- Brushed satin finish, other finishes on request
- 3M adhesive pad fixing (included)
- Also available as combination with 2 or 3 hooks



Round or Square



Round or Square

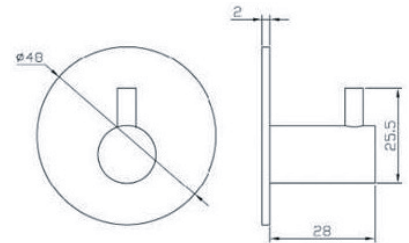

SX-ML-1101-01-SSS

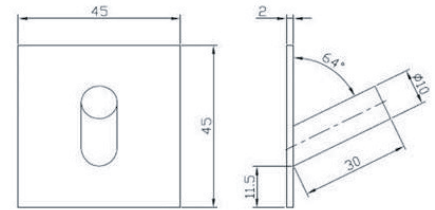

SX-ML-1092-01-SSS

Product code	Description	Finish
SX-ML-1101-01-SSS	Round coat hook	Satin stainless steel
SX-ML-1105-01-SSS	Square coat hook	Satin stainless steel
SX-ML-1090-01-SSS	Round coat hook	Satin stainless steel
SX-ML-1092-01-SSS	Square coat hook	Satin stainless steel