

Door Stop - Floor Mounting Half Moon

Specification

- Stainless steel AISI Grade 304
- Half moon designs with 3mm rubber cushion
- Size Ø44 x 26.5mm
- Anchor pin and fixing screw

Features

- Brushed satin finish, other finishes on request

Product code	Finish
SX-DS-7004-SSS	Satin stainless steel

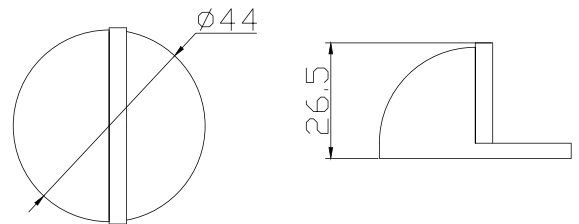

Door Stop - Floor Mounting Cylindrical

Specification

- Stainless steel AISI Grade 304
- Cylindrical design
- Size 40mm x Ø29 / 35mm
- Concealed fixing

Features

- Brushed satin finish, other finishes on request

Product code	Finish
SX-DS-7001-SSS	Satin stainless steel

