

## Electric Outside Access Handle

### Application

- For use with emergency exit devices on doors where access control is required
- Suitable for wood and metal door sets

### Specification

- Electrified outside handle
- 12/24V AC/DC 1A auto select power supply
- Adjustable\* timed opening 3-20 seconds
- LED and audible signal on opening
- Serial interface for connection to access control system
- Reversible lever is "idle" when not in use
- Zinc alloy die cast handle and body
- Powder coated paint finish
- Cylinder operation in case of power loss

### Features

- Suits 400 and 600 series exit hardware with 1, 2 or 3 locking points
- Reversible for right or left hand doors
- Standard colour silver (RAL 9007)

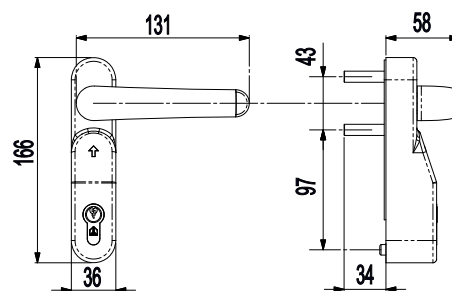
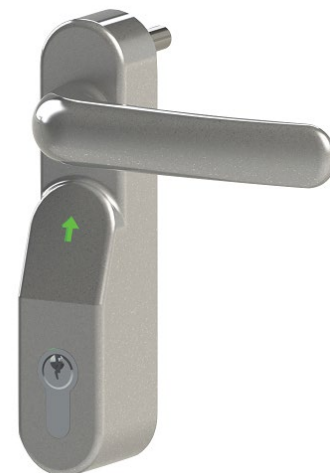

\* opening timing must be set before installation

Opening time setting

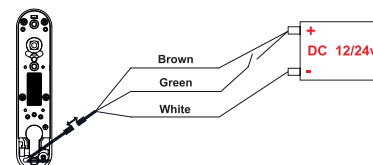
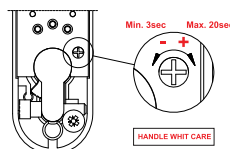

Description	Unit	Min. Value	Standard	Max. Value
Power Supply	V-AC	-10%	12....24	-10%
	V-DC	-10%	12....24	-15%
Standby Power Consumption	mA		22	35
Peak Power Consumption	mA		1100	1200
Holding Current	mA (DC)		160	
Current Draw in Hold Open Mode	mA (DC)		130	

Product code	Description	Finish
1095/G7/VEK	Electric outside access handle	Silver