

85mm series

Latch

Application

- For light commercial and residential applications
- Suitable for wooden doors

Specification

- Mortice latch backset 45mm
- Ball bearing follower
- Latch operation by lever and cylinder
- Suitable for through fixing handles

Features

- Reversible for right or left hand doors
- Satin nickel finish - other finishes on request
- Can also be used as a mortice night latch

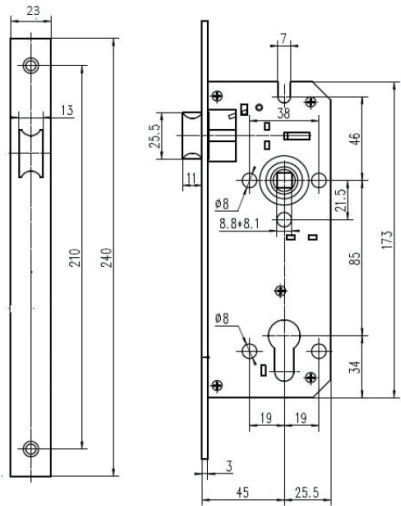

Product code	Description	Finish
LC-1B-8545-04-SN	Motice Latch	Satin nickel